

333

WASHINGTON STREET
POWERHOUSE ARTS DISTRICT, JERSEY CITY

EXCLUSIVE LEASING AGENT:



8,500 SF* RETAIL SPACE

ON GROUND FLOOR OF 50,000 SF COMMERCIAL LOFT BUILDING

*DIVISIBLE

200+
WRAPAROUND
FRONTAGE

SIGNAGE
OPPORTUNITY ON
TWO FACADES

DEDICATED
PRIVATE
ENTRANCE

100+
MORGAN STREET

100+
WASHINGTON STREET





**OVERSIZED
WINDOWS**

**EXPOSED
BRICK**



**12+'
CEILING HEIGHT**

**HEAVY FLOOR
LOADS**

**EXPOSED
WOOD
CEILINGS**

- RENT UPON REQUEST
- TWO-STORY ATRIUM LOBBY
- LOCATED IN DESIRABLE POWERHOUSE ARTS DISTRICT OF JERSEY CITY
- DIVISIONS CONSIDERED, WITH DEDICATED PRIVATE ENTRANCES
- FAÇADE SIGNAGE OPPORTUNITY ON BOTH SIDES OF BUILDING



WASHINGTON STREET

MAJOR NEIGHBORING TENANTS



COMING SOON
2 BLOCKS FROM 333 WASHINGTON STREET



WASHINGTON STREET

- RETAIL
- RESIDENTIAL
- CORPORATE

STEPS FROM EXCHANGE PLACE & GROVE STREET NYNJ PATH STATIONS

NY WATERWAY

NJ TRANSIT HUDSON-BERGEN LIGHT RAIL

NJ TRANSIT BUSES

MINUTES DRIVE FROM NJ TURNPIKE & HOLLAND TUNNEL

NEARBY CITIBIKE STATIONS

VIA PUBLIC BUS SERVICE PICKUPS

Walk Score
95

Transit Score
82

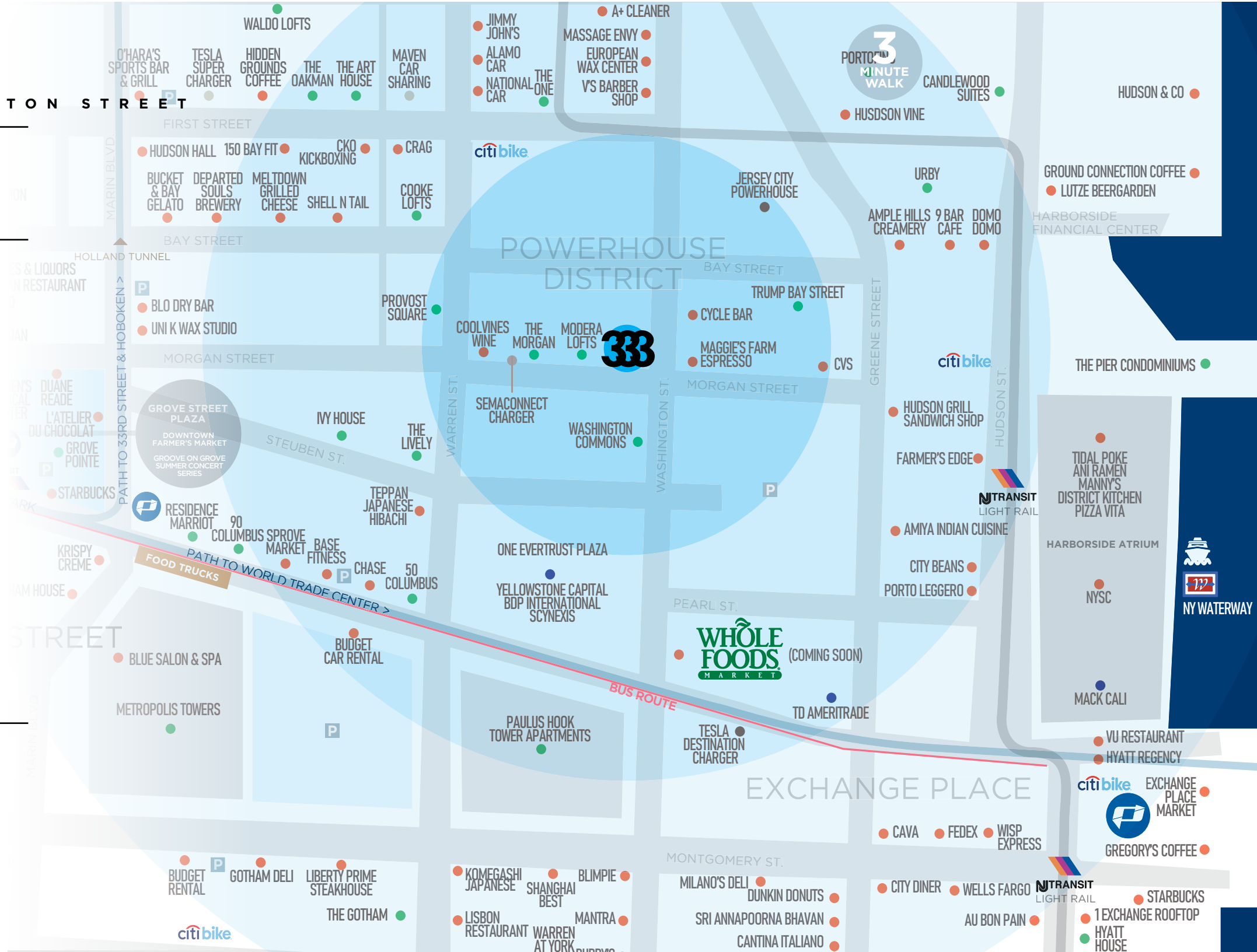



WASHINGTON STREET

TRADE AREAS & FLOOR PLAN

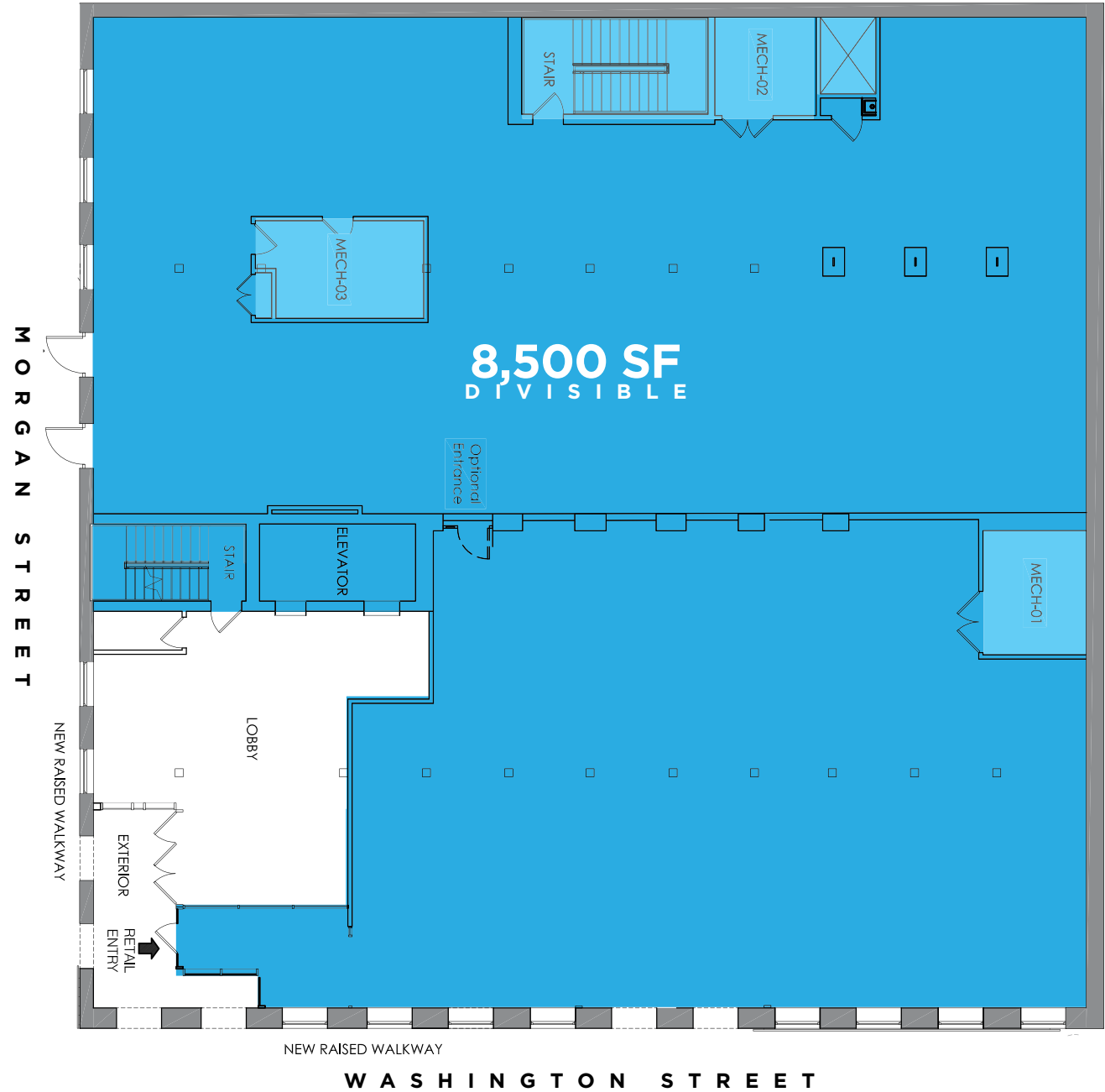



WASHINGTON STREET
POWERHOUSE ARTS DISTRICT, JERSEY CITY

NEIL SETH | 212.841.5063 | neil.seth@cushwake.com

DAVID TOWNES | 917.993.5515 | david.townes@cushwake.com

ALANA FRIEDMAN | 201.508.5258 | alana.friedman@cushwake.com

EXCLUSIVE LEASING AGENT:

